

CUTRIGHT & PRIHODA, INC.  
Architects & Planners  
111 East Travis, Suite 222  
La Grange, Texas 78945

979/968-8888 SENDER'S DIRECT LINE  
979/968-8887 FAX

SENDER'S E-MAIL: brad@cutrightprihoda.com

**ADDENDUM NO. 1  
REQUEST FOR PROPOSAL (RFP)  
JACKSON COUNTY HISTORIC JAIL  
RENOVATION & ADDITION  
RFP 22-02**

**Project Name:** JACKSON COUNTY  
HISTORIC JAIL  
RENOVATION & ADDITION  
**Location:** Edna, Texas 77957  
**Addendum Date:** May 13, 2022  
**RFP Date:** May 10, 2022  
**Architect's Project No.:** 22.739

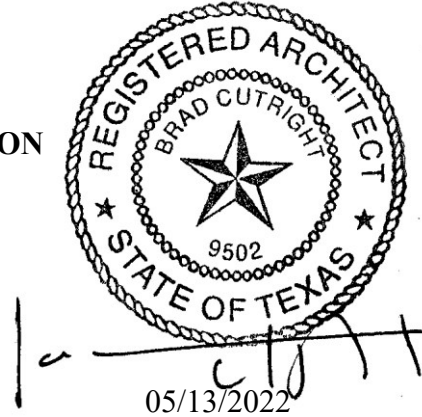

**NOTICE TO PROPOSERS**

The Request for Proposals (RFP) will be amended, revised, corrected and/or supplemented by this Addendum hereinafter specified and all Work affected by the Addendum will be included.

This Addendum will be considered part of the RFP previously issued for the above referenced project as though it had been issued at the same time and will be incorporated integrally therewith.

Proposers are hereby notified that they will make any necessary adjustments to their Bid Proposal as a result of this Addendum. Each Proposer will acknowledge this Addendum in their Proposal indicating that their Proposal is submitted with full knowledge of all modifications and supplementary data specified herein or attached herewith.

**SPECIFICATIONS**

<b>Sections No.</b>	<b>Item No.</b>	<b>Description of Change</b>
Proposal Documents	a.	REQUEST FOR PROPOSAL – CONSTRUCTION MANAGER-AT-RISK; <u>NOTE</u> address for Mandatory Pre-Proposal Meeting location 116 W. Cypress St., Edna, Texas may not show up properly on Google Maps. Please note, the Historic Jail is located on the corner of Cypress St. and Ed Linn St. across the street from First Assembly of God Church.

- b. FEE QUOTE CONSTRUCTION MANAGER-AT-RISK; ADD  
Addendum Acknowledgment, See Attachment No. 1 new Fee Quote  
Form.

**DRAWINGS**

**ISSUE THE FOLLOWING SHEET**

<u>Sheet No.</u>	<u>Item No.</u>	<u>Description of Change</u>
	a.	SITE PLAN dated 12 May 2022, See Attachment No. 2. For your information this plan is included.

---

**END OF RFP ADDENDUM NO. 1**

Distribution List:

County Judge Jill Sklar, [j.sklar@co.jackson.tx.us](mailto:j.sklar@co.jackson.tx.us)

County Judge Assistant, Michele Matejek, [m.matejek@co.jackson.tx.us](mailto:m.matejek@co.jackson.tx.us)

County Auditor Michelle Darilek, [m.darilek@co.jackson.tx.us](mailto:m.darilek@co.jackson.tx.us)

Commissioner Pct. 2, Wayne Bubela, [wbubelajc2@ykc.com](mailto:wbubelajc2@ykc.com)

BLS Construction, Inc., William Key, [william.key@blsconstruction.com](mailto:william.key@blsconstruction.com)

Bass Construction Company, Inc., Bob Bass, [bob.bass@bassconstruction.com](mailto:bob.bass@bassconstruction.com)

Polasek Construction, Inc., Greg Polasek, [greg@polasekconstruction.com](mailto:greg@polasekconstruction.com)

K&T Construction Co. Inc., Larry Tomanek, [ltomanek@ktconstruction.com](mailto:ltomanek@ktconstruction.com)

file

FEE QUOTE  
CONSTRUCTION MANAGEMENT-at-RISK  
Jackson County Historic Jail Renovation & Addition, Edna, Texas  
RFP #22-02

To: Jackson County Auditor  
Michelle Darilek, County Auditor  
411 N. Wells, Room 201  
Edna, Texas 77957

Project: Jackson County Historic Jail Renovation & Addition  
Edna, Texas

Offer: (Company Name) \_\_\_\_\_  
(Address) \_\_\_\_\_  
(Telephone and Fax) \_\_\_\_\_

We, the undersigned, hereby offer to enter into an Agreement to furnish Construction Management-at-Risk/Contractor Services for the following Fee Structure as outlined below.

**Proposal A - Fees for Construction Manager-at-Risk for Pre-Construction Phase Services**

In Words  
(A LUMP SUM OF \_\_\_\_\_) \$ \_\_\_\_\_

**Proposal B - GENERAL CONDITIONS FOR THE WORK (Available in EXCEL format upon request)**

See the attached spreadsheet "GENERAL CONDITIONS LUMP SUM" for all items to be priced as a Lump Sum.

In Words  
(A LUMP SUM OF \_\_\_\_\_) \$ \_\_\_\_\_

**Proposal C - Contractor's Mark Up for Profit the General Conditions in Proposal B are subject to the Contractor's mark up.**

In Words ( \_\_\_\_\_ PERCENT) \_\_\_\_\_ %

**Proposal D - Change Order Markups and Credits as a %**

In Words ( \_\_\_\_\_ ) \_\_\_\_\_ %

**Proposal E - Contract Time in Calendar Days**

\_\_\_\_\_ days.

**ATTACHMENT No. 1**  
ADDENDUM No. 1 05-13-22  
JACKSON COUNTY  
HISTORIC JAIL  
RENOVATION & ADDITION

**ADDENDUM ACKNOWLEDGMENT**

Having examined the Proposal Documents and Drawings of the Project listed above, dated **10 May 2022**, including Addenda numbered \_\_\_\_\_ through \_\_\_\_\_, inclusive, as prepared by the Architect, and having visited the site and examined all conditions affecting the Project, the undersigned proposes to perform the complete Work of the Project for the fees as stated herein.

**ACCEPTANCE**

This offer shall be open to acceptance and is irrevocable 30 days from the Due Date.

**PROPOSAL FORM SIGNATURE(S)**

The Corporate Seal of: \_\_\_\_\_

(Seal)

was hereunto affixed in the presence of:

\_\_\_\_\_  
(Signature of Authorized Signing Officer)

\_\_\_\_\_  
(Title)

If the Proposal is a joint venture or partnership, add additional forms of execution for each member of the joint venture in the appropriate form or forms as above.

---

**END OF FEE QUOTE**

<p><b>ATTACHMENT No. 1</b> <b>ADDENDUM No. 1</b>    05-13-22 <b>JACKSON COUNTY</b> <b>HISTORIC JAIL</b> <b>RENOVATION &amp; ADDITION</b></p>
--

ED LINN ST

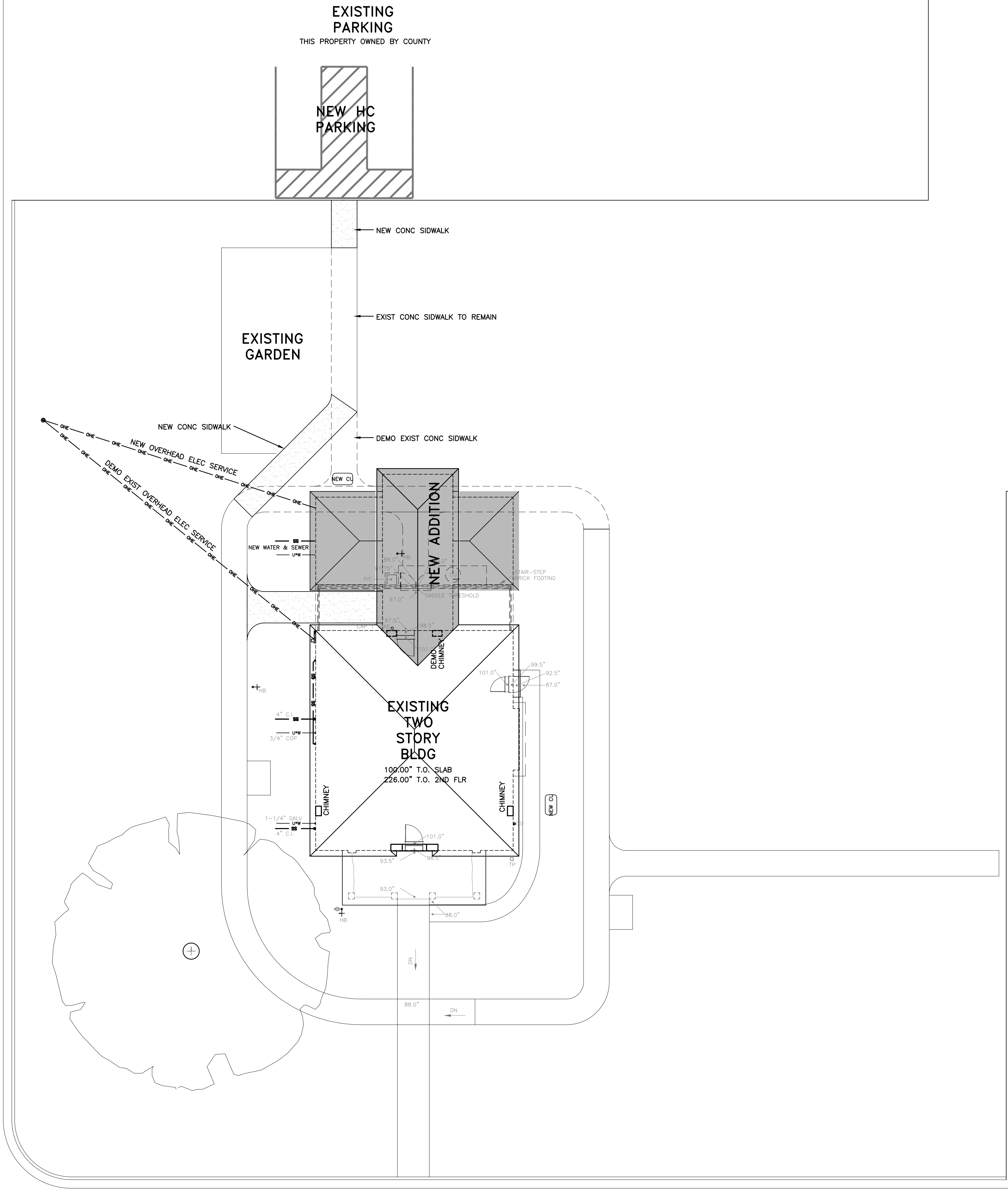

PARKING

CYPRESS ST

PRESENTATION DRAWING:  
 THIS DRAWING IS A SCHEMATIC  
 PRESENTATION INTENDED TO  
 ILLUSTRATE DEVELOPMENT OF THE  
 PROJECT TO DATE. THIS DRAWING IS  
 SUBJECT TO CHANGE BY ENGINEERING  
 REQUIREMENTS, BUILDING CODES OR  
 OTHER ADJUSTMENTS THAT COULD  
 IMPACT ITS FINAL APPEARANCE.  
 COPYRIGHT CUTRIGHT & PRIHODA, INC  
 2022

**SITE PLAN**  
 SCALE 10' 12 MAY 2022  
**JACKSON COUNTY HISTORIC JAIL**

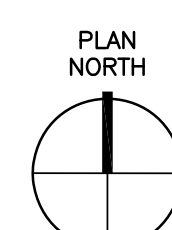

ATTACHMENT No. 2  
 ADDENDUM No. 1 08-13-22  
 JACKSON COUNTY  
 HISTORIC JAIL  
 RENOVATION & ADDITION